

Presentation Hardware range

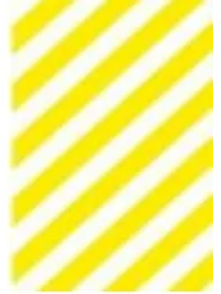

Our terminals



Clocking terminals designed from a **use**

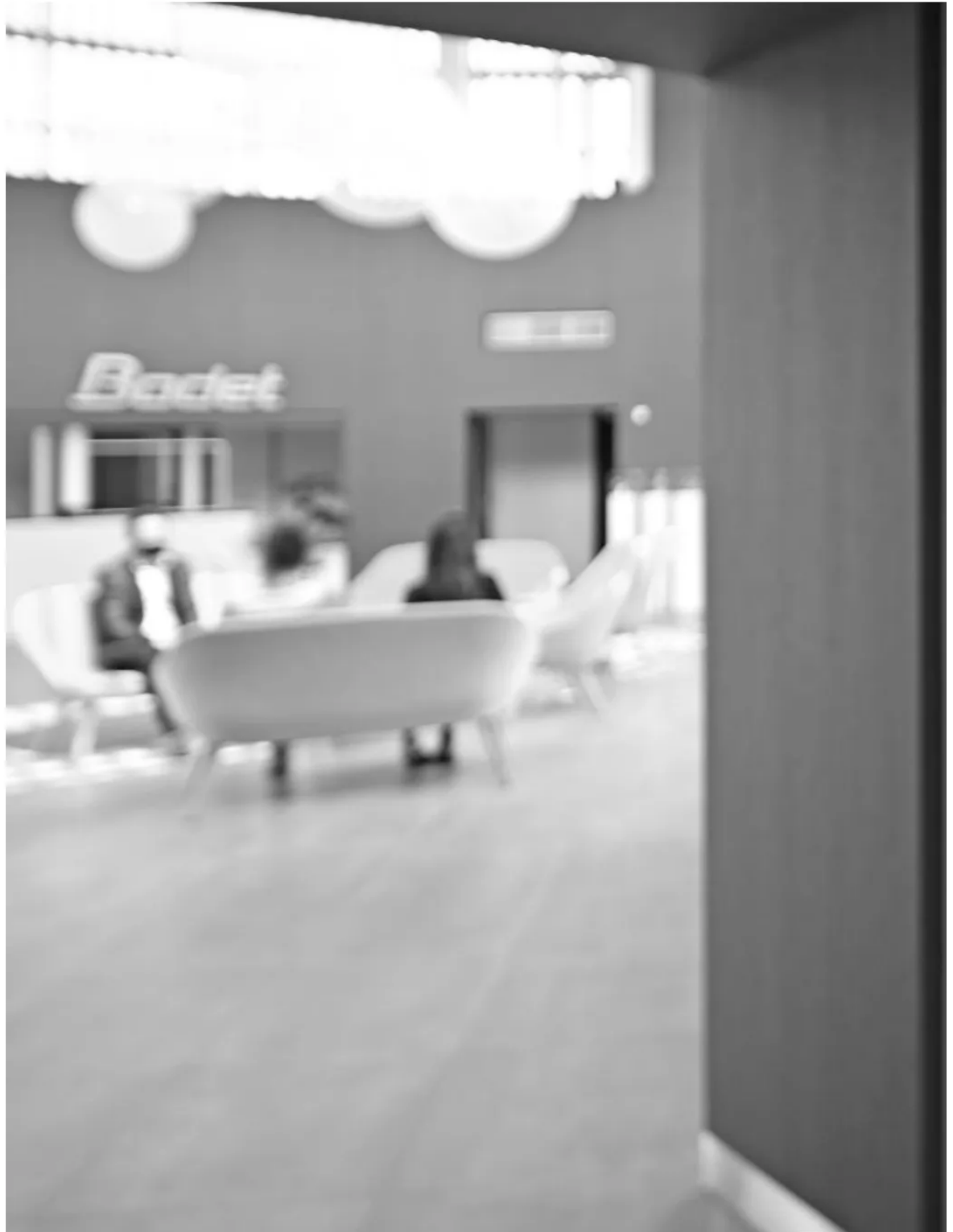



r's perspective





Kelio **Visio** **X4**

The small
touch
terminal



FUNCTIONS



Time & Attendance management

- Starting/ending attendance time
- Starting/ending an absence or a business leave



Activity monitoring

- Starting/ending an activity
- Entering notes and quantities



Access control

- Door opening
- Consulting room reservations



FUNCTIONS

Time & Attendance management



- Starting/ending attendance time
- Starting/ending an absence or a business leave
- Declaring one's attendance

Activity monitoring



- Starting/ending an activity
- Entering notes and quantities

Absence requests

- Making an absence request



Access control

- Door opening
- Visitors terminal
- Room reservation



Collaborative tools

- Suggestions box
- Survey



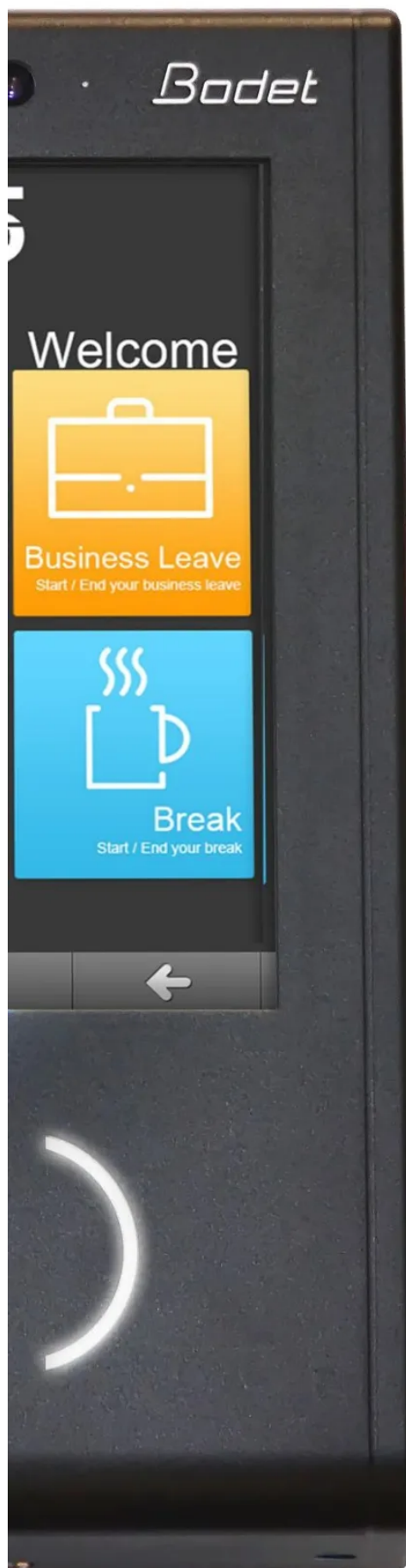

Kelio Visio X7

Developed for
your
requirements
Simple and
intuitive
Ultra-
customisable

TERMINALS TO SUIT YOU



KELIO APPS

All applications are available on the Kelio Visio X7. The Kelio Visio X4 can also carry a majority of apps.

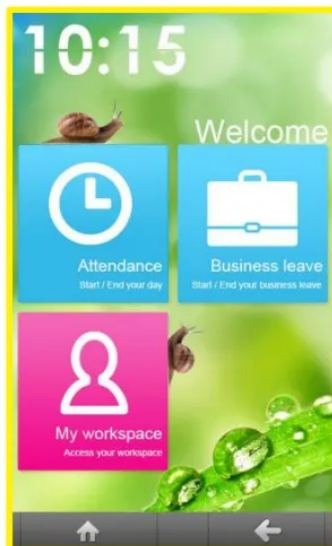

HOME SCREEN

may be customised with the organisation's colours using a specific background, logo or graphic charter

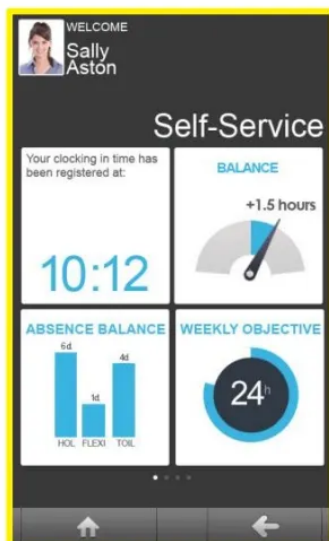

USER AREA

Connection to user accounts with access to Kelio Apps, results and graphs.

X7

accessories

Transparent
cover w/o access
to the touch
screen

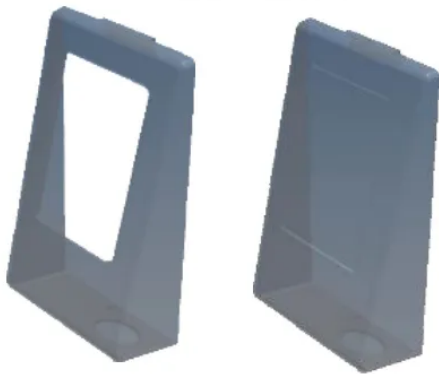

Plastic screen
protective film

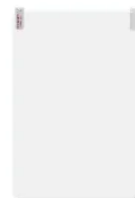

(Temperature-
controlled)
waterproof box



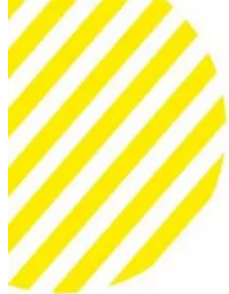

Kelio Xtrem

The terminal
designed for all
environments,
even the most
extreme



FUNCTIONS

Connected Time & Attendance management terminal

- Sending of clockings in real-time

Standalone Time & Attendance management terminal

- Clocking retrieval via USB stick on mobile work sites

Secure access reader

- Opening of an access in sensitive areas



Shockproof

Resistant to the cold

Resistant to heat

Resistant to dust



IK08
IP65



TECHNICAL CHARACTERISTICS

	Kelio Visio X4	Kelio Visio X7	Kelio Xtrem
Identification modes	RFID, Bluetooth Low Energy/NFC, Code, Fingerprint	RFID, Bluetooth Low Energy/NFC, Code, Fingerprint	RFID, Bluetooth Low Energy/NFC, Code, Fingerprint
Dimensions (WxHxD, mm)	109.4 x 220 x 75	147.5 x 290.5 x 100	76.5 x 216.5 x 99.5
Screen	4.3" Resistive touch display	7" Capacitive touch display	41.8 x 27x 9 mm High-contrast OLED
Camera	As an option	As a standard	No
Communication mode	Ethernet As an option: Wi-Fi and GSM	Ethernet As an option: Wi-Fi and GSM	Ethernet TCP/IP or USB
Operating temperature	0 °C to +40 °C	-0 °C to +40 °C	-15 °C to +50 °C
Weight of the terminal	513 g	1500 g	585 g
Outdoor use	No	No	Yes
Functions	Start/end Document reader Web User area Messaging Door opening Entering notes and quantities Consulting room reservations	Start/End Document reader Web User area Messaging Door opening Entering notes and quantities Room reservation Attendance declaration Absence Visitors Terminal Suggestions box Survey Rules/extensions	Clocking Attendance indication Clocking up to 3 activity levels Choice of daily schedule
Declinations	MIFARE DESFire/Classic/ Bluetooth Low Energy/NFC Electronic Marin HID Proximity UID Legic iCLASS	MIFARE DESFire/Classic/ Bluetooth Low Energy/NFC Electronic Marin HID Proximity UID Legic iCLASS	MIFARE DESFire/Classic/ Bluetooth Low Energy/NFC Electronic Marin Stid

Identification modes



Leather keyfob



Plastic keyfob



Tag



Plastic card



Fingerprint



Bluetooth
Low Energy /
NFC



Facial recognition

758934

Personal code

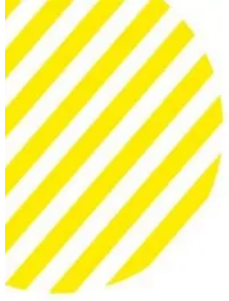

FaceStation 2

Smart face
recognition
terminal



FACIAL RECOGNITION



Time and Attendance management

- High speed face matching
- Contactless badges for up to 2000 users
- High quality face image logs
- Can be used in bright light conditions (25,000 lx)
- Infra-red based fake face blocking technology

Access control management

- In the office
- In food processing factories or hospitals where hygiene is important
- In data centres, research institutes and banks that require improved security

Key Functions FaceStation

- Exceptional performance and usability
- Installation can be adjusted from 145 cm to 210 cm



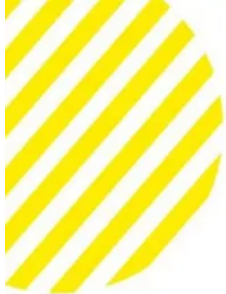

FaceLite

Compact face
recognition
terminal



TECHNICAL CHARACTERISTICS

	FaceStation2	FaceLite
Identification modes	Facial recognition	Facial recognition
Dimensions (WxHxD, mm)	109.4 x 220 x 75	147.5 x 170 x 76
Screen	4" Colour	2" Colour, non-touch screen
Photo taken	Colour	Black and white
Ethernet	10/100/1000 Mbps	10/100/1000 Mbps
Operating temperature	-20 °C to +50 °C	-20 °C to +50 °C
Power supply	Power supply 24Vdc 2.5A (not included)	Power supply 24Vdc 2.5A (not included)
Weight of the terminal	548 g	296 g
Compatibility with Kelio	From version 3.3 onwards	From version 4.3E onwards
Result consultation	No	No
Outdoor use	No	No

Our readers



A **multi-purpose range** adaptable to





suit all uses and environments





Kelio Pass



The design-led
secure access
reader



Access control / Time Attendance management

Clocking in or out can trigger an alarm

Job costing management

The reader can be dedicated to a specific job

Alarm management

The reader can be used to trigger a fire alarm



Kelio Pass

Tamper-proof

Ultra-resistant
access reader



**me &
agement**

gger the opening of a door

agement

ted to an activity

:

o identify people in the event of



Access reader **with** **keyboard**

Multi-purpose
reader for
badge and
keyboard



TECHNICAL CHARACTERISTICS

	Kelio Pass	Kelio Pass Tamper-proof	Keyboard reader
Identification modes	RFID, Bluetooth Low Energy/NFC	RFID, Bluetooth Low Energy/NFC	RFID, Code
Dimensions (WxHxD, mm)	68.5 x 126 x 38	113 x 184 x 46.5	80 x 106.64 x 26
Power supply	12/24Vdc PoE 13 W	12/24Vdc	12Vdc
Connection	RS485 polling RS485 OSDP V2 Ethernet IP	RS485 polling RS485 OSDP V2	RS485 on protocol converter
Operating temperature	-15 °C to +60 °C	-15 °C to +60 °C	-20 °C to +70 °C
Protection	IP54 IK08	IP65 IK08	IP65 IK08
Outdoor use	Yes	Yes	Yes
Declinations	MIFARE DESFire/Classic/ Bluetooth Low Energy/NFC Electronic Marin HID Proximity	MIFARE DESFire/Classic/ Bluetooth Low Energy/NFC Electronic Marin HID Proximity	MIFARE Classic MIFARE DESFire CSN MIFARE Classic CSN MIFARE DESFire



Escutcheon readers



Design-le
access



Access control n

Cylinder-integrated a
Wireless link betwe
escutcheon/cylinder c
just change the door l
accesses

Ideal for installing ac
doors



Handles



ed secure
devices

Cylinders



management

ccess readers

en the
and the access system -
handle for internal

ccess control on existing

TECHNICAL CHARACTERISTICS



	Escutcheon readers	Handles	Cylinders
Identification modes	RFID	RFID	RFID
Dimensions (WxHxD, mm)	41 x 312 x 195	55 x 56 x 13.5	43 x 32 mm (L x Ø)
Power supply	Lithium battery CR123A	Lithium battery CR123A	Lithium battery CR2
Connection	Wireless on RS485	Wireless on communication hub RS485	Wireless on communication hub RS485
Operating temperature	-25 °C to +60 °C	0 °C to +55 °C	-20 °C to +55 °C
Protection	IP54	IP42	IP65
Outdoor use	Yes	No	No
Declinations	Mifare DESFire Kelio number	Mifare DESFire Kelio number	Mifare DESFire Kelio number



Biometric reader **BIOENTRY P2**

High-
security
access
reader



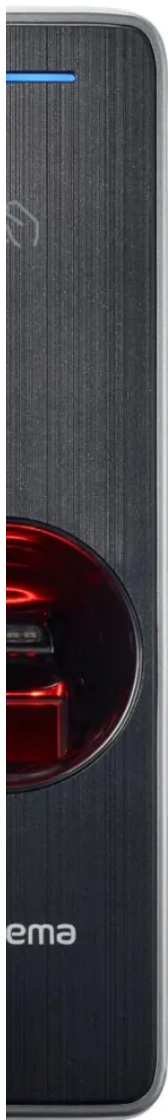
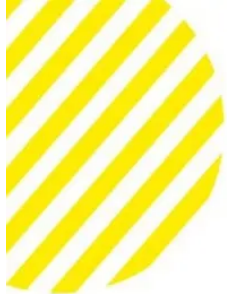

Biometric reader **BIOENTRY W2**

An access
reader for
outdoor
use

TECHNICAL CHARACTERISTICS

	BIOENTRY P2	BIOENTRY W2
Identification modes	Fingerprint	Fingerprint
Dimensions (WxHxD, mm)	50 x 164 x 37.5	50 x 172 x 43.5
Power supply	12Vdc 1.5A	12Vdc 600mA
Connection	Ethernet IP Slave of a Visio X7, X4 or P6 controller	Ethernet IP PoE Slave of a Visio X7, X4 or P6 controller
Operating temperature	-20 °C to +50 °C	-20 °C to +50 °C
Weight of the terminal	201 g	251 g
Protection	-	IP67 IK09
Outdoor use	No	Yes
Declinations	Electronic Marin 125 kHz MIFARE Classic MIFARE DESFire HID Proximity	Electronic Marin 125 kHz MIFARE Classic MIFARE DESFire HID Proximity

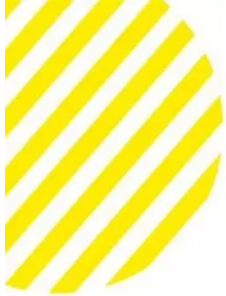

RECOGN VEHICLE

Convert
number plates ...



Access control

After declaring their nu
employee records, staf
vehicle (work or person
Number plate recogniti
Kelio **Visitor Manag**
record the arrival of an
them access.



ITION OF : PLATES



...into
access
badges!

member plates in their
f can enter with their own
al).

on can be connected to
ement and used to
identified visitor and grant

[illegible]



image your equipment

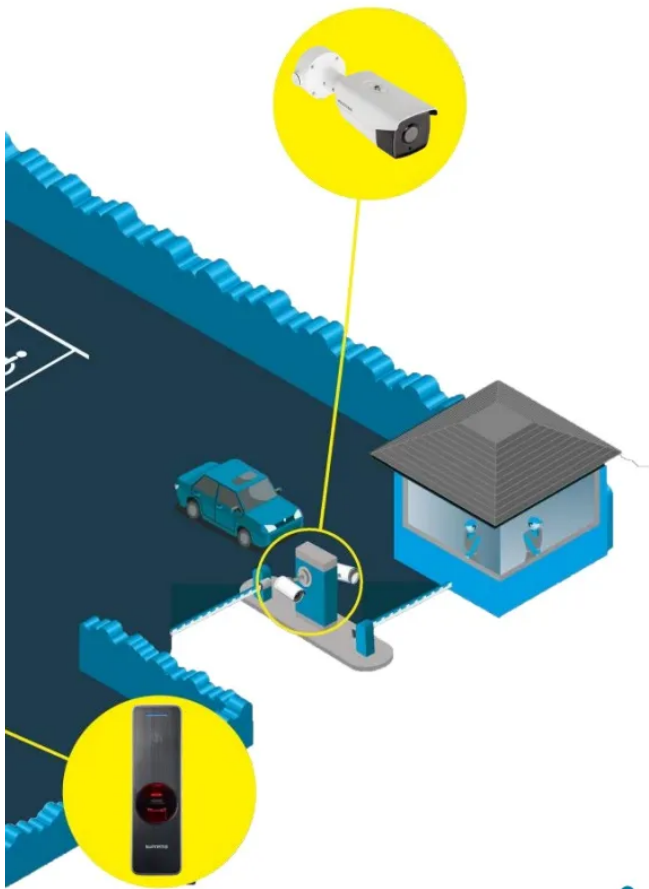

SUITABLE FOR:

- EMERGENCY EVACUATION SYSTEMS



- BUILDING MANAGEMENT SYSTEMS



Hardware architecture

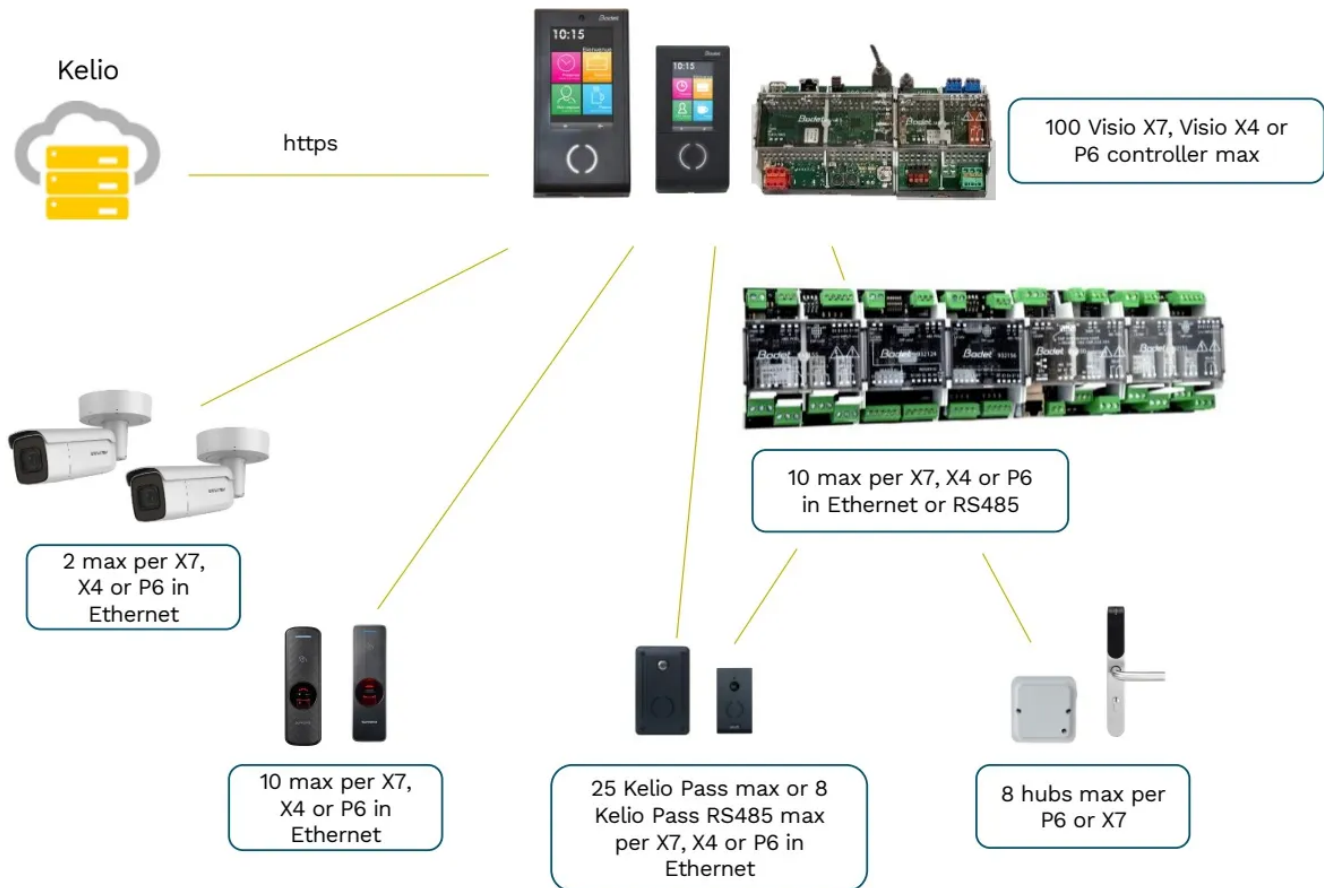

Removable **spring wire terminal blocs** to prevent from cabling errors

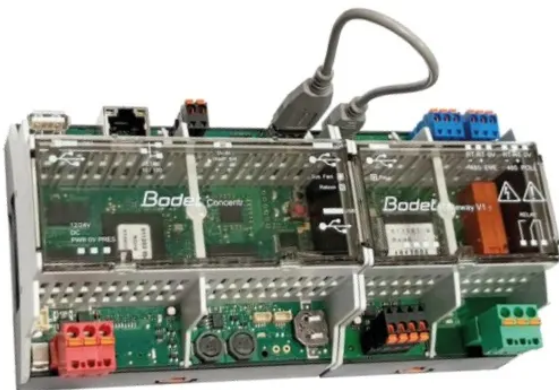

Visual information using **LEDs**

- Input/output communication
- Input/output status (active or inactive)
- Hardware connection status



One **colour** for each use

- **Red:** Supply slots
- **Black:** Input slots
- **Green:** Output slots
- **Blue:** RS485 slots

HARDWARE

P6 CONTROLLER

- IP connection between Kelio server and the terminals (access control or time and attendance). Compatibility with legacy products.
 - Capacity: 2000 employees and 25 peripheral devices
 - Size: 6M
 - Power supply: 12V or 24Vdc



RS GATEWAY OSDP V2

- Slave module, to be connected via USB to the P6 controller.
- Management of RS485 peripherals. 2 inputs, 1 output.
 - Connection: USB, RS485
 - Size: 4M
 - Mounting on DIN rail
 - Power supply: USB



READER INTERFACE

- 1 door management (standalone) or up to 8 doors management with additional modules.
 - Connection: Ethernet IP or RS485 event
 - Size: 4M
 - Mounting on DIN rail
 - Power supply: 12/24V PoE, Max. output current 600mA

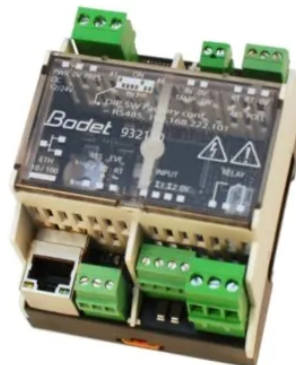

8-INPUTS MODULE

- 8 dry contact inputs
 - Connection: RS485 connection to the RIV4 (2 maximum) or to a concentrator (8 maximum)
 - Size: 3M
 - Mounting on DIN rail
 - Power supply: 12/24 V



HARDWARE

4-INPUTS / 4-OUTPUTS MODULE

- Management of 4 inputs and 4 outputs
 - Connection: RS485 connection to the RIV4 (2 maximum) or a concentrator (8 maximum)
 - Size: 4M
 - Mounting on DIN rail
 - Power supply: 12/24 V

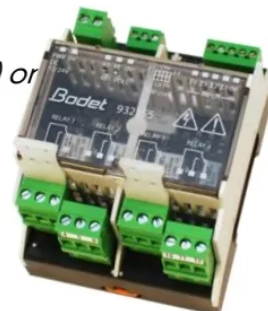

SLAT DIN RAIL POWER SUPPLY 12V/ 24V

- Output current 4/3A maximum shared on both outputs
 - Size: 7M
 - To be fixed on DIN rail in a box
 - Power supply: Single-phase voltage 110V-240V 50-60Hz



POWER SUPPLY 12V NON-BACKUP 1.5A MODULE

- Output 12Vdc 1.5A
 - Size: 1M
 - To be fixed on DIN rail in a box
 - Power supply: 230Vac 50Hz



BOXES

- Modular boxes of different sizes:
 - Box 18 Modules
 - Box 25 Modules
 - Box 65 Modules
 - Power supply box 12V backup 3A
 - Pack Reader Interface 1 door management PoE
 - Pack Reader Interface 1 door management with 12V backup power supply
 - Pack Reader Interface 1 door management 230V non-backup power supply
 - Pack Reader Interface 5 doors management 12V backup power supply
 - Pack Reader Interface 5 door management 12V non-backup power supply





GLOBAL WORK-LIFE SOLUTIONS

95,9 %

of customers are
**satisfied with our
products and services**

(2023 survey based on 5,800
responses)

99,3 %

of customers are
**satisfied
with our after sales
support**

(2023 survey based on 6,100
responses)

20

software
languages
options

20,000

customers
worldwide

5 Million

users everyday

€ 72.900,000

turnover

560

employees

37 years

of **expertise**

Everyone in our organisation shares with you its key skills and its expertise in the areas of time and attendance management, human resources management and access control, in order to provide you with support and to guarantee the success of your project.

Audit

Functional review

Supported rollout

Project mode rollout

Post-production follow-up

Installation

Training

Setup

Support



Terminals



Readers



Cameras

ANPR camera readers



Facial recognition

FaceStation2 FaceLite





Access control material

Access commands



Power supply



Boxes



Badges

Card



Keyfob



Sticky tags



Badge racks



Kelio

Boulevard du Cormier
CS 40211
49302 CHOLET Cedex
FRANCE



www.kelio.com

Kelio



REF 654281 D1